

Traffic— design Konstantin Grcic, 2016



Following the entire collection of upholstered seating launched in 2013, which was joined last year by the coffee tables, again with a metal rod frame, now comes the turn of Traffic table.

Playing on different proportions, the basic concept of Traffic is elaborated in a new form: once again we find slender steel rod frames that create soft geometric volumes, giving rise this time to a sizeable table/trestle, ideal for both domestic and contract

settings.

Konstantin Grcic



Designer in Magis



[magisdesign.com](http://magisdesign.com)

**Traffic**— design Konstantin Grcic, 2016  
Technical Sheet

**Table. Pair of trestles.**

**Material:** frame in steel rod, painted in polyester powder. Top in painted MDF.

Magis logo is stamped on each product of our collection vouching for their originality.

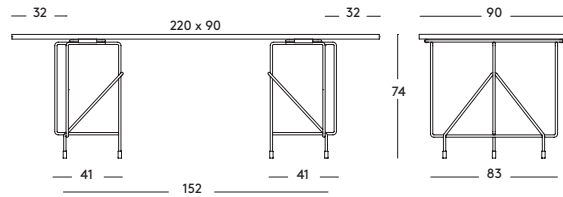

Frame: White 5108  
Top: White 8500



Frame: Black 5140  
Top: Black 8510



[magisdesign.com](http://magisdesign.com)



**Konstantin Grcic**

Konstantin Grcic was born in 1965 and studied Design at the Royal College of Art in London. Since setting up his own practice, Konstantin Grcic Industrial Design (KGID), in Munich in 1991, he has developed furniture, products and lighting for some of the leading companies in the design field. Konstantin Grcic defines function in human terms, combining strict forms with considerable mental acuity and humour. Each of his products expresses a careful research into the history of design and architecture, and his passion for technology and materials. Known for his pared-down pieces, Grcic is often called a minimalist, but the designer himself prefers to speak of simplicity.

